

# GREENE COUNTY JUVENILE OFFICE

2010  
CHILD ABUSE & NEGLECT (ABN)  
STATISTICS

# Abuse & Neglect Numbers

- On average, there were 874 children in care involving an average of 526 families.
- | <u>Referrals</u> | <u>total</u> | <u>average</u> |
|------------------|--------------|----------------|
| ● Family         | 364          | 30/month       |
| ● Children       | 614          | 51/month       |
- | <u>Filings</u> | <u>total</u> | <u>average</u> |
|----------------|--------------|----------------|
| ● Family       | 296          | 25/month       |
| ● Children     | 506          | 42/month       |
- Petitions were filed on 82% of the referrals received.

# ABN Referrals & Filings

ABUSE & NEGLECT REFERRALS & FILINGS FOR 2010

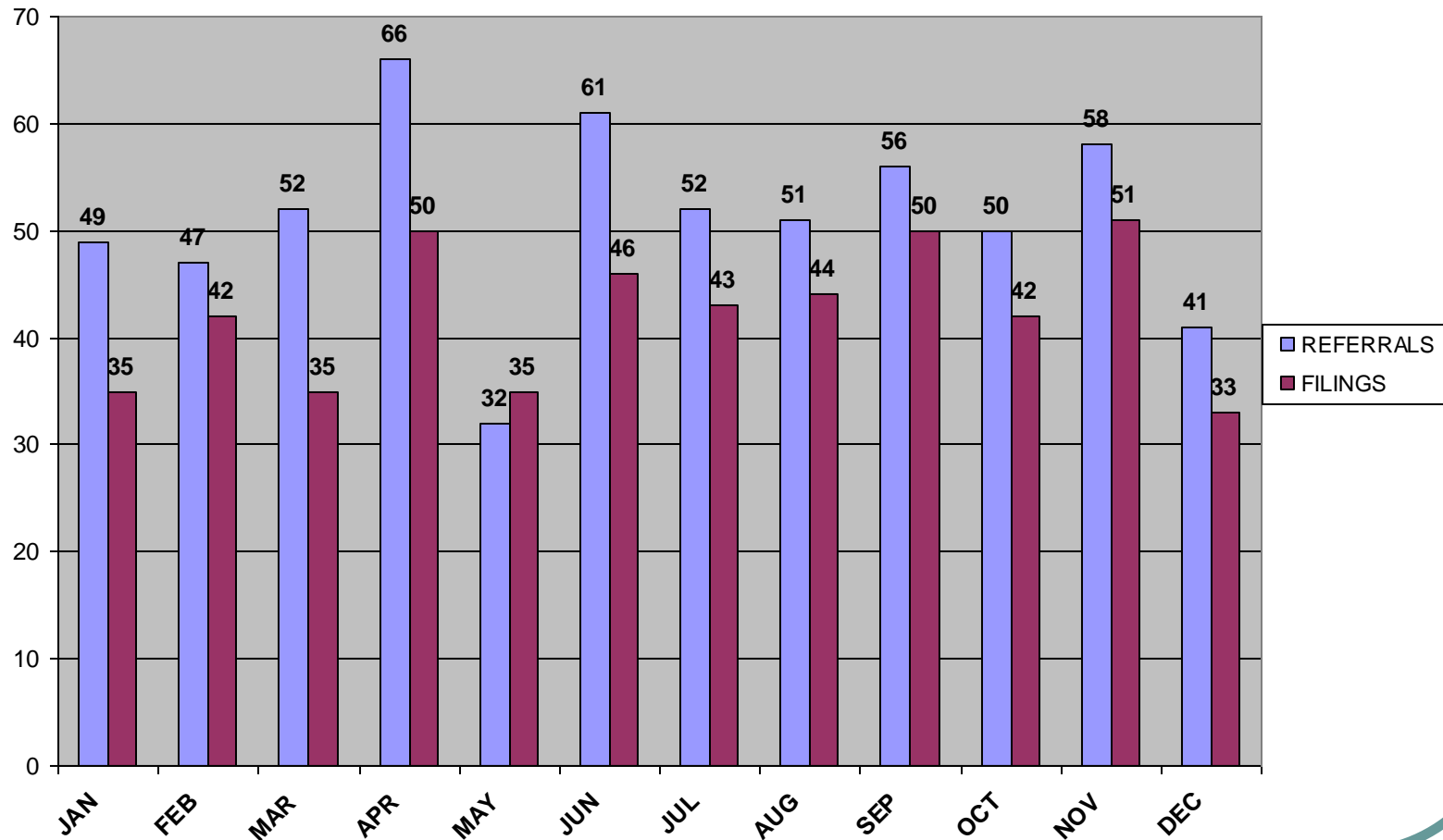

# ABN Referrals & Filings by Age Groups

2010 ABUSE & NEGLECT REFERRALS AND FILINGS BY AGE GROUPS

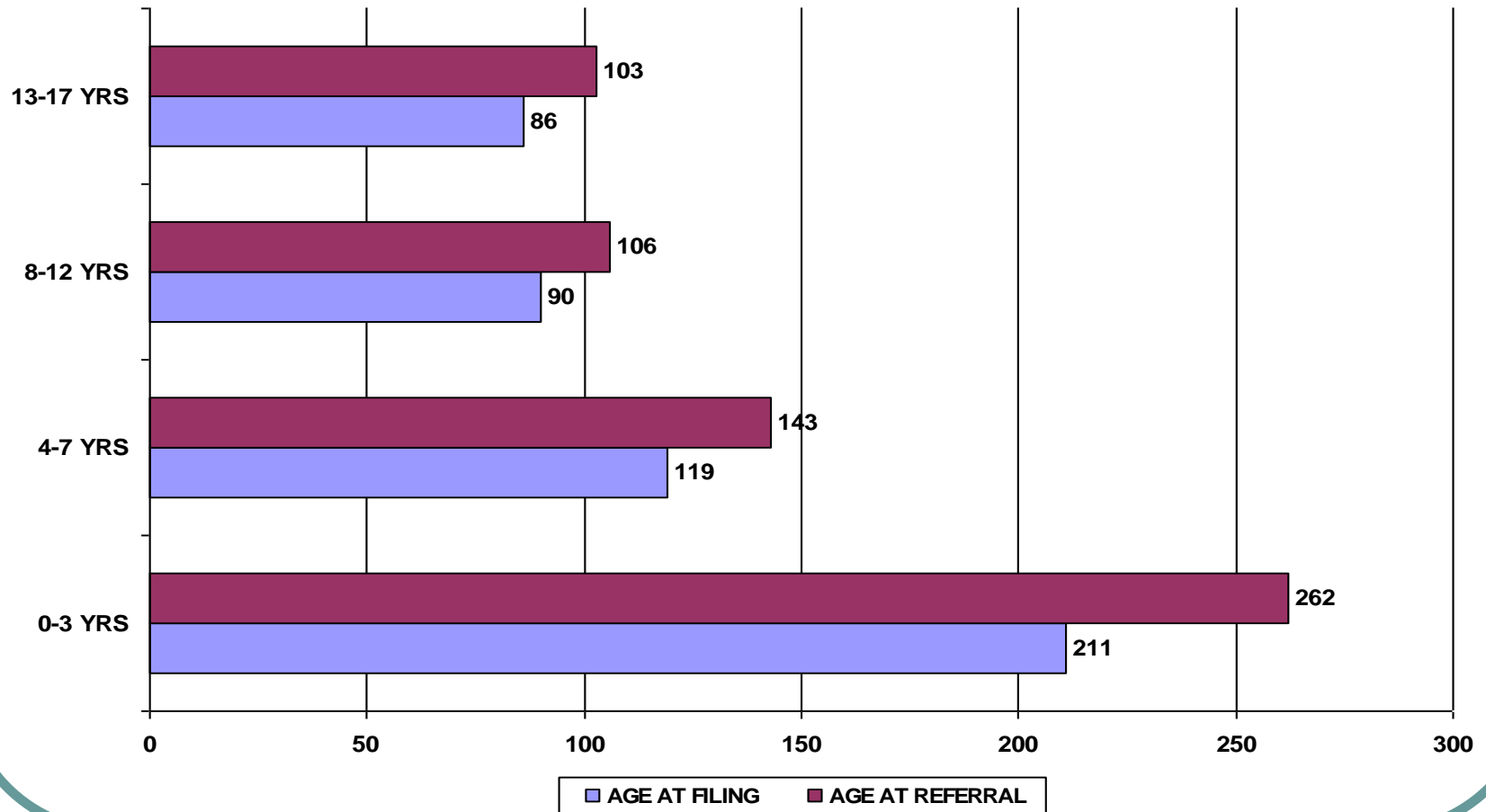

# Abuse & Neglect Referral Allegations

## ● Allegation Types

● Chronic Neglect	297	40%
● Drugs/Alcohol	257	35%
● Physical Abuse	62	8%
● Protective Custody	70	10%
● Sexual Abuse	22	3%
● Medical Neglect	21	3%
● Abandonment	4	1%
● Educational Neglect	1	0%
● Emotional Abuse	1	0%

\*Chronic Neglect includes lack of supervision, unsafe/unsanitary housing & lack of supervision\*

# ABN Referral Allegations

Abuse & Neglect Referral Allegations 2010

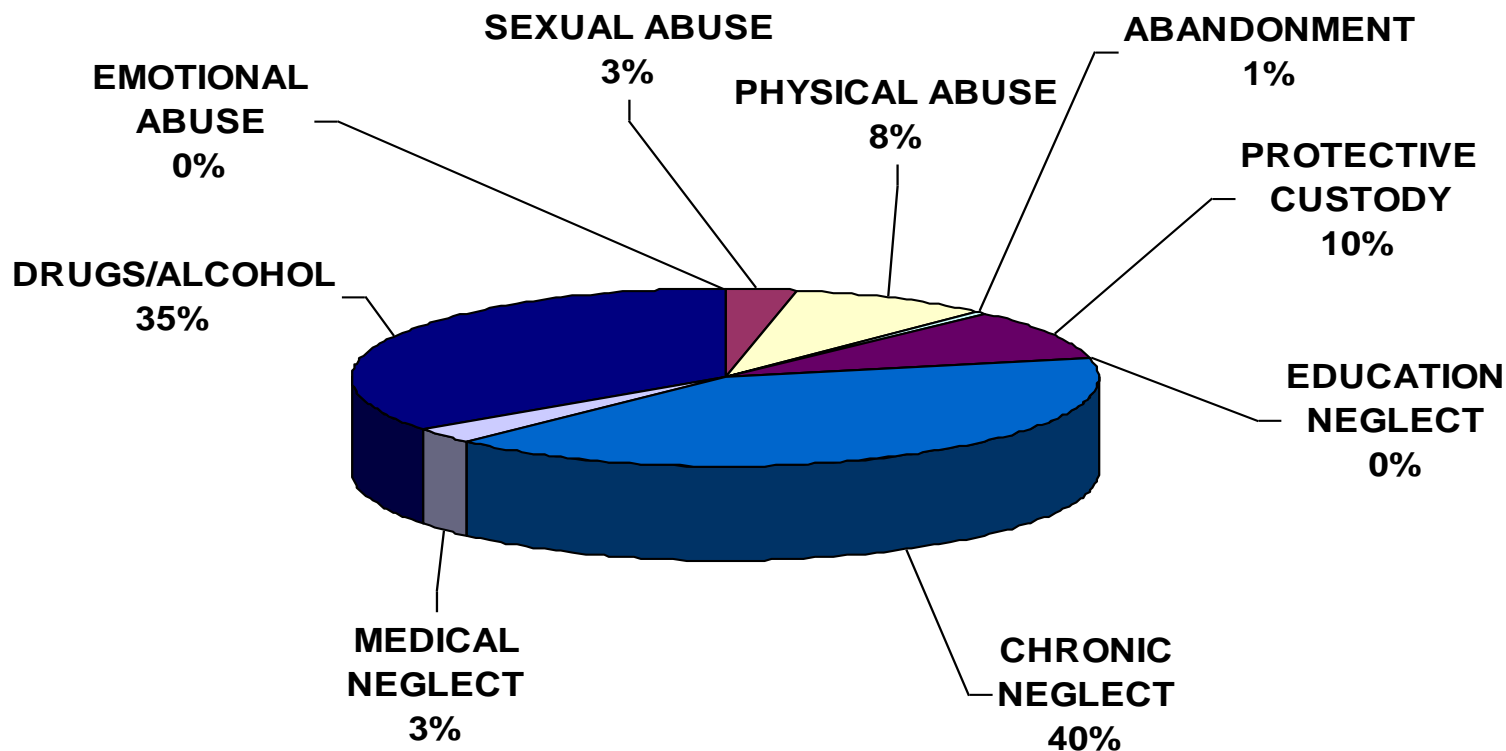

\*Chronic Neglect includes lack of supervision, unsafe/unsanitary housing & lack of supervision\* 6

# Controlled Substance Referrals

- **Drugs & Alcohol involved ABN Referrals**
- **Family**
  - Referrals 167
  - Filings 142
- **Children**
  - Referrals 291
  - Filings 261
- **Petitions were filed on 90% of referrals received involving drugs &/or alcohol.**

# Controlled Substance Referrals

DRUGS OF CHOICE  
2010

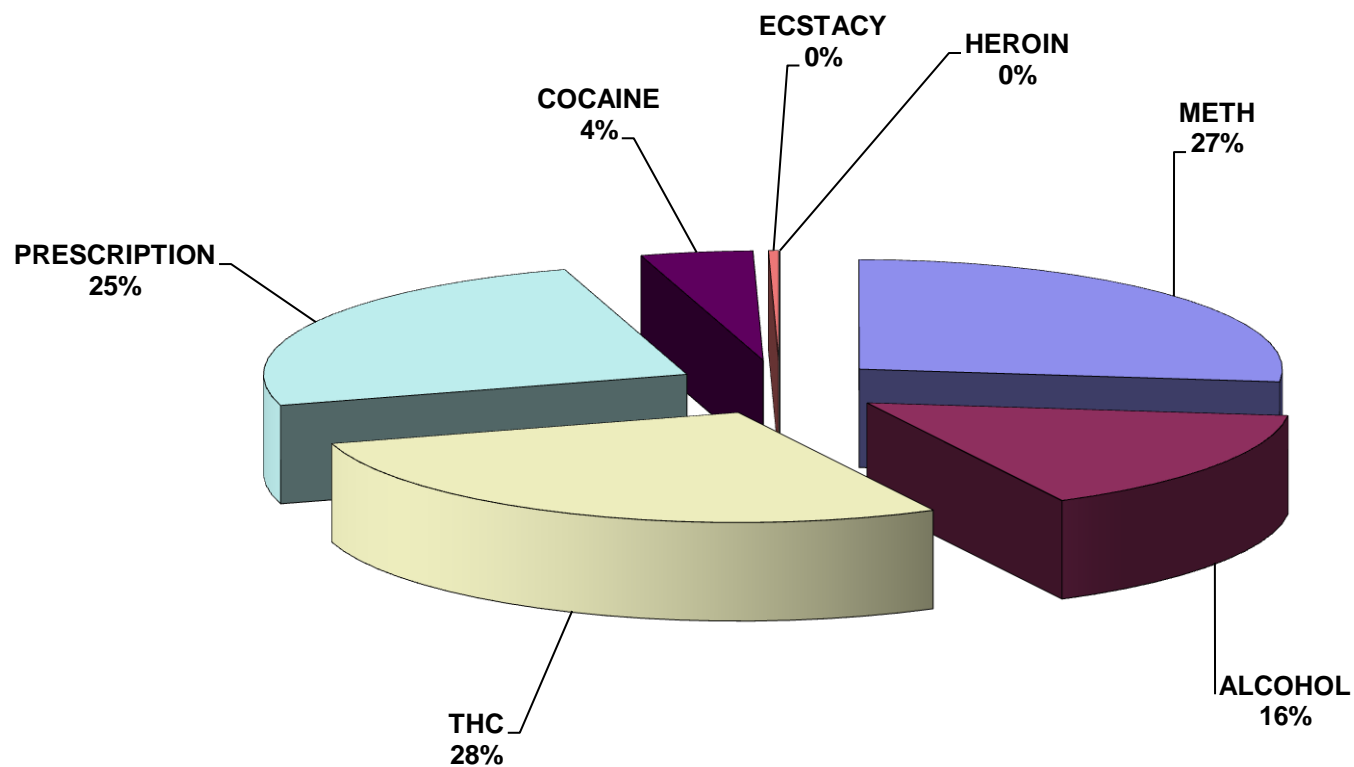

40% OF the 167 FAMILIES HAD REPORT OF POLYSUBSTANCE USAGE



# Controlled Substance Referrals

Controlled Substance Related Referrals by Month

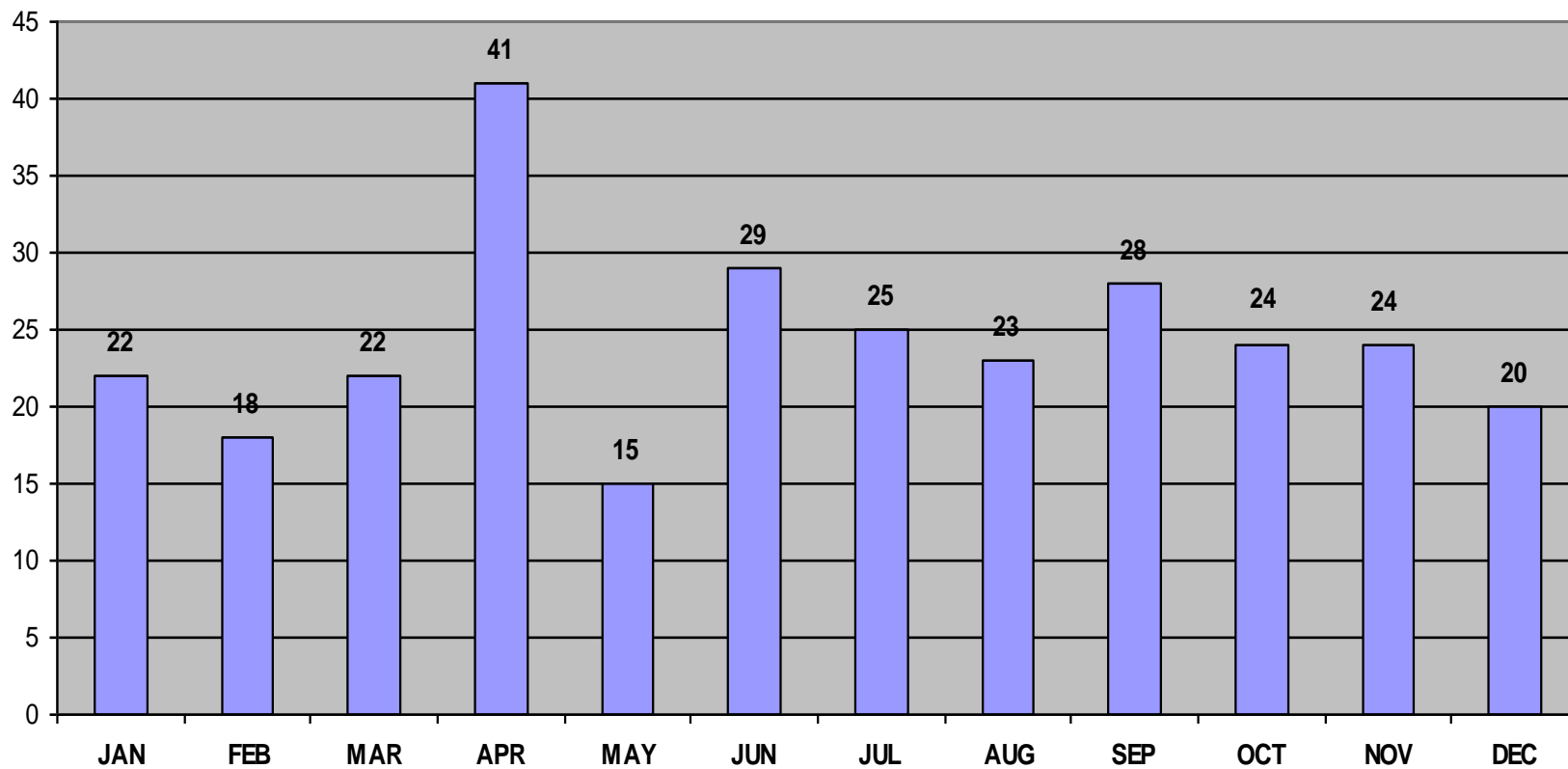

# Abuse & Neglect Case Closings

- **There were 376 children's cases closed.**
  - **Reunification** 171 45%
  - **Adoption** 145 39%
  - **Independence** 23 6%
  - **Guardianship** 18 5%
  - **Run Away** 15 4%
  - **Transfer Jurisdiction** 2 1%
  - **Transfer to DYS** 1 0%
  - **Transfer to DMH** 1 0%
  - **Deceased** 0 0%

**\* Reunifications increased by 5% from 2009 \***

# Permanency Outcomes

## CHILD ABUSE & NEGLECT CASE CLOSING OUTCOMES 2010

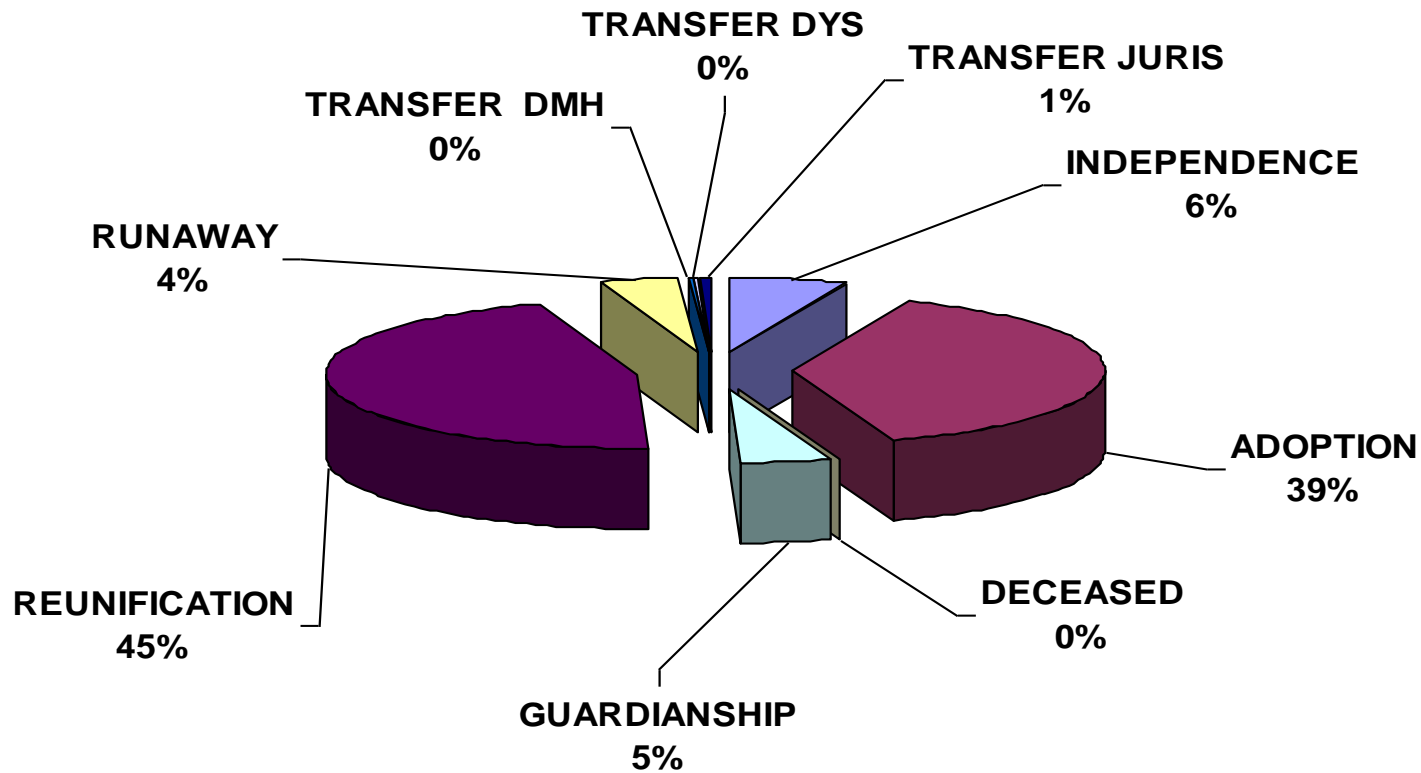

# Ethnicity of Greene County Children

ETHNICITY OF GREENE COUNTY FOSTER CHILDREN  
AS OF JANUARY 1, 2011

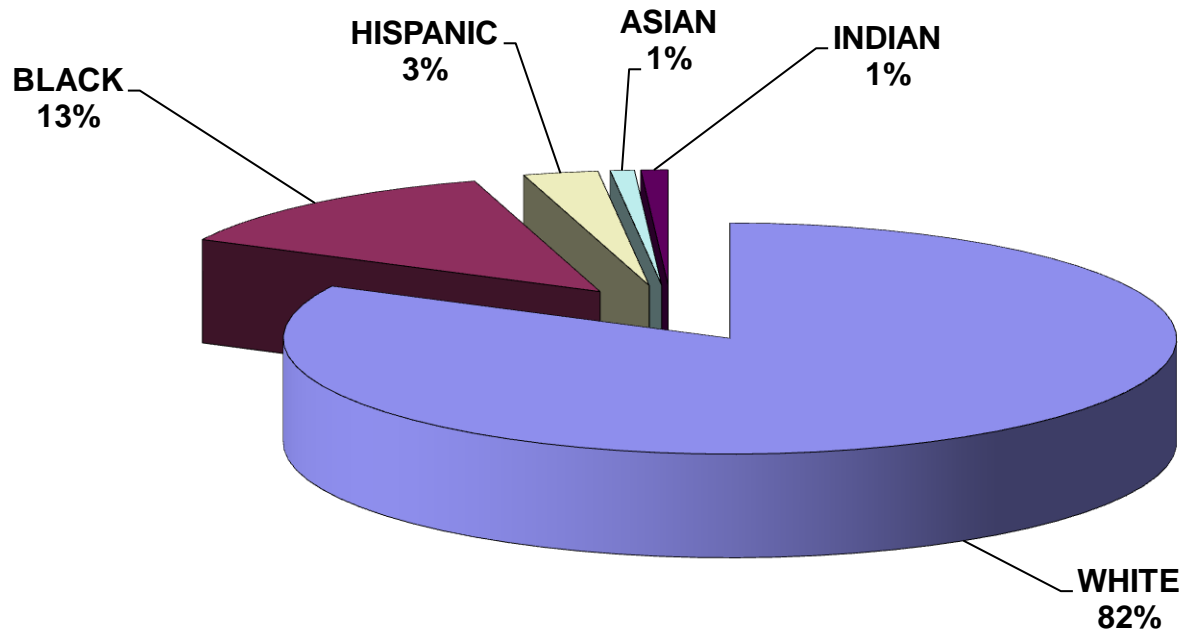

# Gender of Greene County Children

**GENDER OF GREENE COUNTY FOSTER CHILDREN  
AS OF JANUARY 1, 2011**

**FEMALE  
45%**

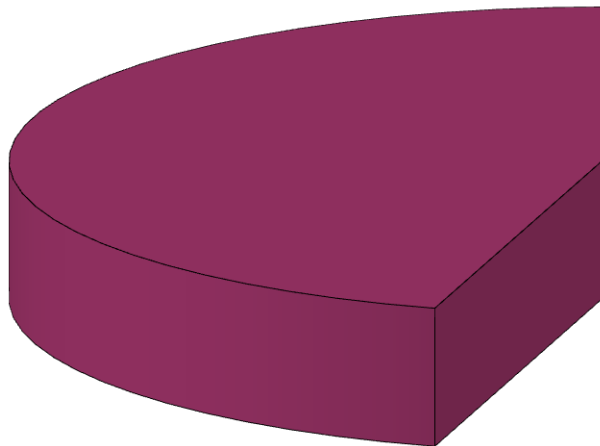

**MALE  
55%**

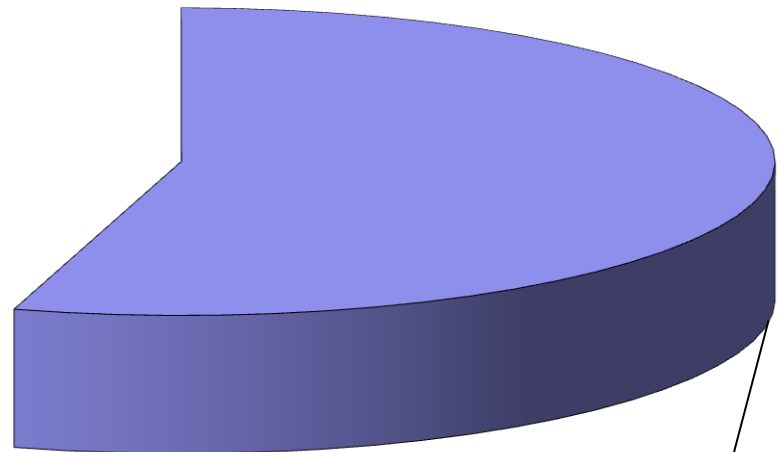

# Ages of Greene County Children

**GREENE COUNTY CHILDREN IN FOSTER CARE BY AGE GROUP  
AS OF JANUARY 1, 2011**

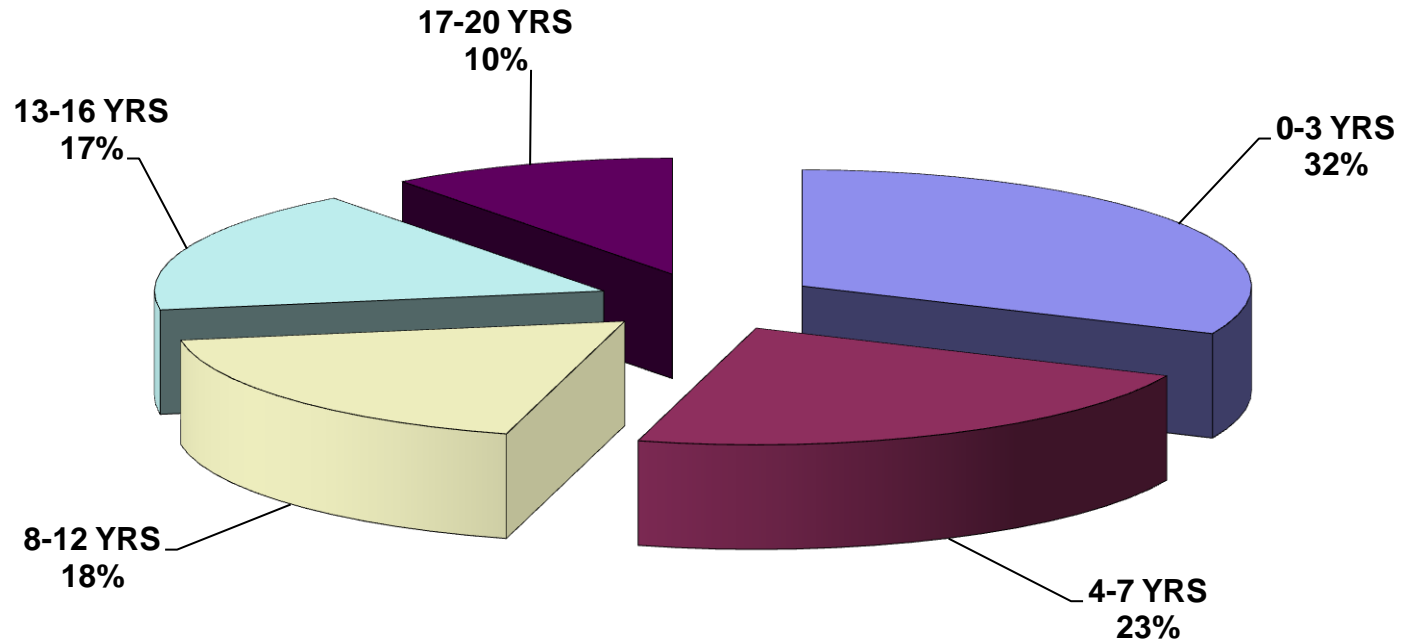

# 5 Year ABN Referral Comparison

ABUSE & NEGLECT REFERRALS FOR 2006, 2007, 2008, 2009 & 2010

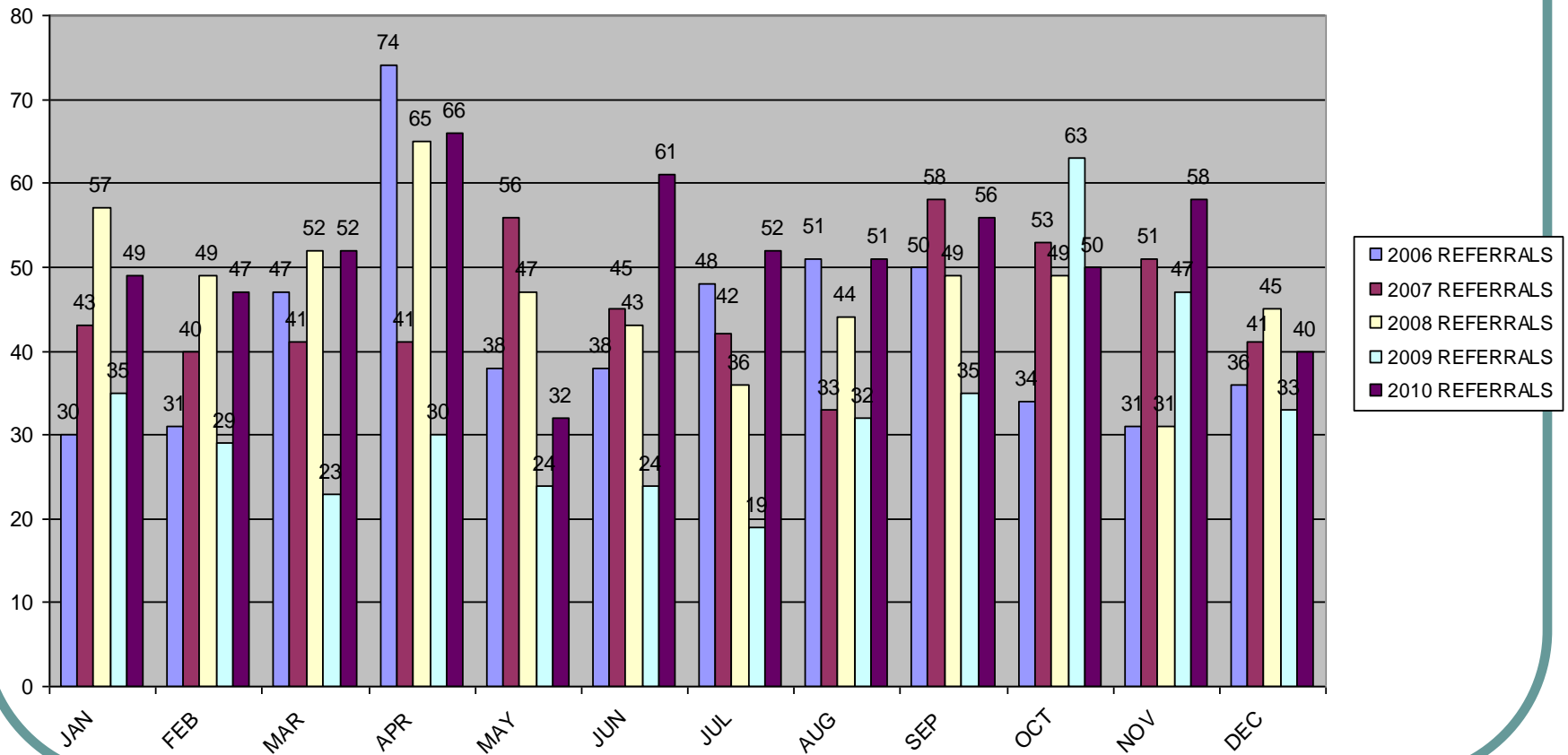

# 5 Year ABN Referral Comparison

ABUSE & NEGLECT REFERRALS FOR 2006, 2007, 2008, 2009 & 2010

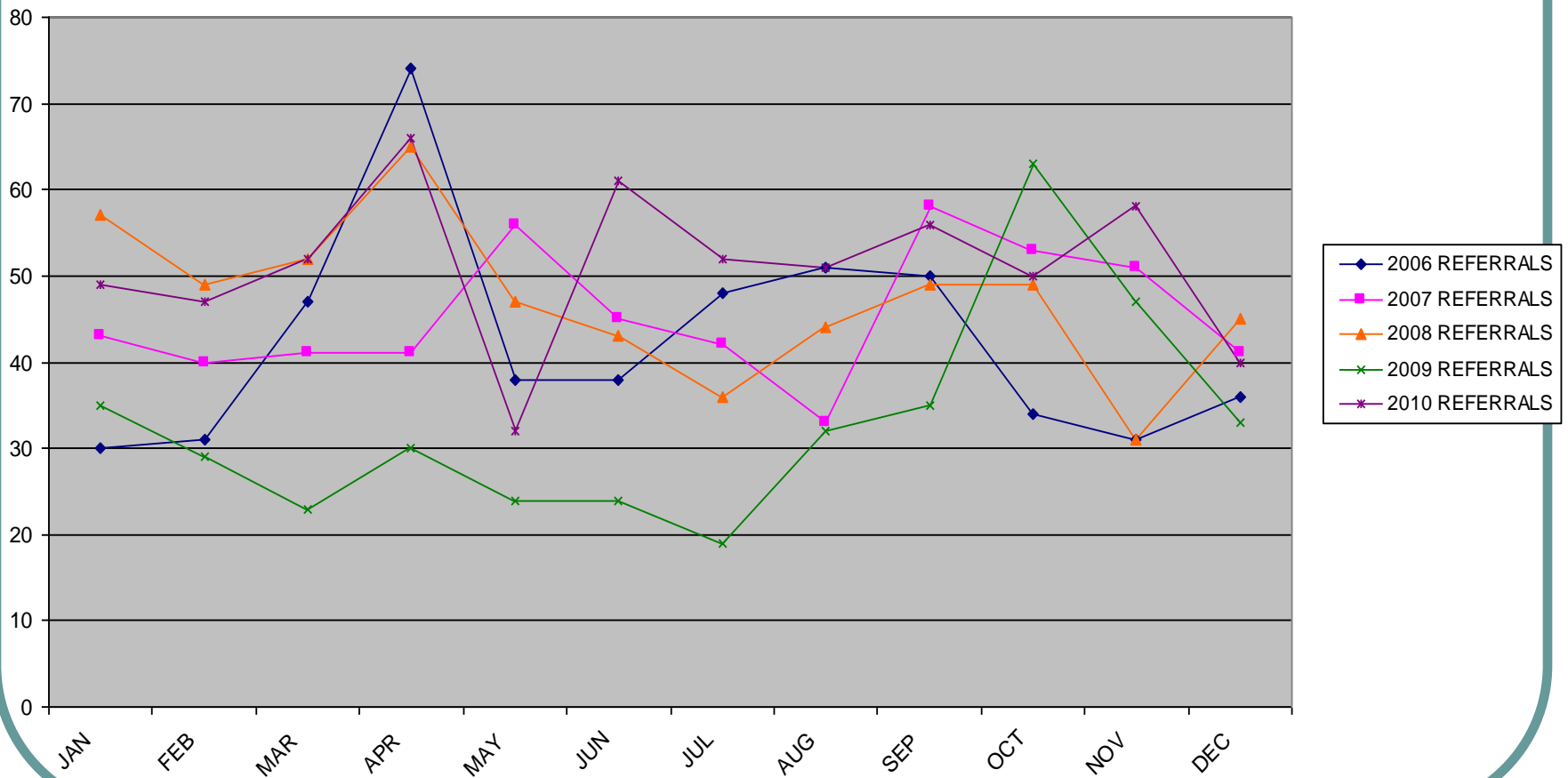



# 5 Year ABN Referral Trends

ABUSE & NEGLECT REFERRALS FOR 2006, 2007, 2008, 2009 & 2010

